

# GRANVILLE STATION

209 STREET & 62 AVENUE  
EDMONTON, ALBERTA

RETAIL SPACE FOR LEASE  
1,200 - 8,200 SQ. FT.



AVAILABLE SUMMER 2016



## PROPERTY FACTS & FEATURES

- Space from 1,200 to 8,200 sq. ft.
- Easy access to the neighbourhoods, Granville, Glastonbury and The Hamptons
- Available in Summer 2016
- Huge residential growth
- Only neighbourhood commercial in the area
- Great parking and signage
- Future connecting road will be built in 2014 to 215 Street



For more information, please contact:

**DUSTIN BATEYKO**

Sales Associate

Ph: (780) 702 4257

dustin.bateyko@cwedm.com

**DOUG FOGG**

Senior Sales Associate

Ph: (780) 702 4260

doug.fogg@cwedm.com

**CUSHMAN & WAKEFIELD EDMONTON**

Suite 2700, TD Tower

10088 102 Avenue

Edmonton AB T5J 2Z1

www.cwedm.com

# GRANVILLE STATION

## Retail Space For Lease

1,200 - 8,200 SQ. FT.  
AVAILABLE

### SITE PLAN

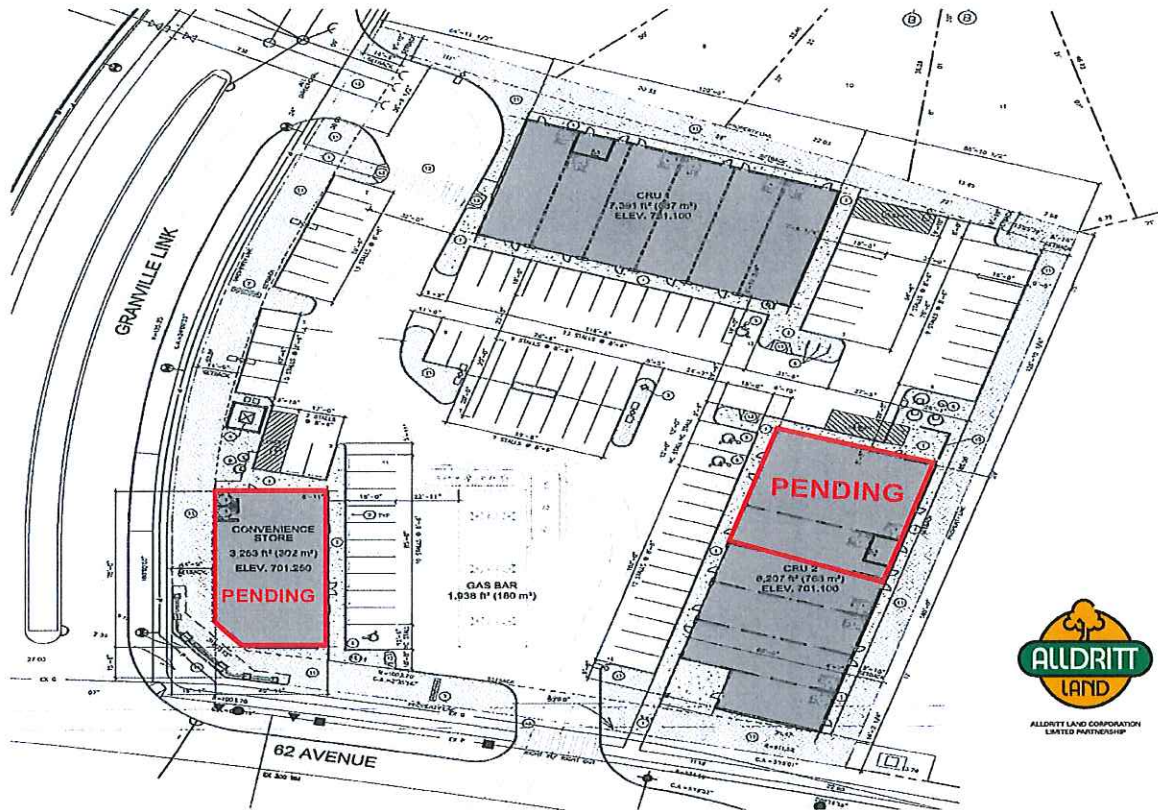

### RENDERING



For more information, please contact:

**DUSTIN BATEYKO**

Sales Associate

Ph: (780) 702 4257

dustin.bateyko@cwedm.com

**DOUG FOGG**

Senior Sales Associate

Ph: (780) 702 4260

doug.fogg@cwedm.com

**CUSHMAN & WAKEFIELD EDMONTON**

Suite 2700, TD Tower

10088 102 Avenue

Edmonton AB T5J 2Z1

www.cwedm.com